

THANK YOU FOR BUYING A BEKO PRODUCT.



**Before using the appliance carefully read the Safety Instruction.**

Before using the machine, it is imperative that the transport bracket is removed. For more detailed instructions on how to remove it, see the Installation Guide.

**CONTROL PANEL**

- 1 Programme selector
- 2 "Start/Pause" button
- 3 "Reset/Drain" button
- 4 "Temperature" button
- 5 "Start delay" button
- 6 Child lock combination
- 7 "Spin" button
- 8 Time
- 9 Temperature
- 10 Washing phase
- 11 Eco monitor

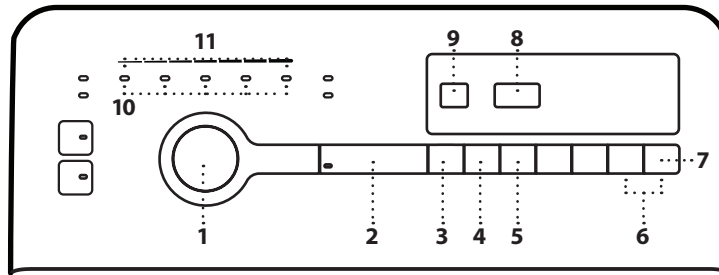

**INDICATORS**

Detergent over dosage

Door open

Failure: Service

Failure: Clean pump

Failure: Water tap closed

In the event of any failure, refer to the "TROUBLESHOOTING" section

**PROGRAMME CHART**

Max load 7,0 Kg Power consumption in off-mode 0,11 W / in left-on mode 0,11 W						Detergents and additives			Recommended detergent		Residual dampness %	Energy consumption kWh	Total water lt	Laundry temperature °C
Programme	Temperatures		Max. Spin speed (rpm)	Max load (kg)	Duration (h : m)	Prewash	Main wash	Softener	Powder	Liquid				
	Setting	Range												
<b>Rapid 30'</b>	30°C	20 - 30°C	1200	3,0	00:30	–	●	○	–	✓	62	0,250	42	26
<b>Eco 40-60</b>	40°C	40°C	1151	7,0	03:25	–	●	○	✓	✓	53	0,806	59	44
			1151	3,5	02:35	–	●	○	✓	✓	53	0,415	40	33
			1151	2,0	02:35	–	●	○	✓	✓	53	0,210	30	24
<b>Aqua saver</b>	40°C	20 - 40°C	1200	2,5	**	–	●	–	–	✓	–	–	–	–
<b>Colours</b>	40°C	20 - 60°C	1000	4,0	**	○	●	○	✓	–	–	–	–	–
<b>Jeans</b>	40°C	20 - 60°C	1000	4,0	**	○	●	○	–	✓	–	–	–	–
<b>Hygiene</b>	60°C	60°C	1200	7,0	**	–	●	○	✓	✓	–	–	–	–
<b>20 °C</b>	20°C	20°C	1200	7,0	01:50	–	●	○	–	✓	53	0,200	55	20
<b>Rinse &amp; Spin</b>	–	–	1200	7,0	**	–	–	○	–	–	–	–	–	–
<b>Spin</b>	–	–	1200	7,0	**	–	–	–	–	–	–	–	–	–
<b>Wool</b>	40°C	20 - 40°C	1000	1,0	**	–	●	○	–	✓	–	–	–	–
<b>Delicates</b>	40°C	20 - 40°C	1000	1,5	**	○	●	○	–	✓	–	–	–	–
<b>Synthetics</b>	40°C	20 - 60°C	1200	3,0	02:15	○	●	○	✓	✓	47	0,630	40	40
<b>Cotton</b>	60°C	20 - 95°C	1200	7,0	02:35	○	●	○	✓	✓	57	1,200	54	56
<b>Mixed</b>	40°C	20 - 60°C	1200	3,0	**	–	●	○	✓	✓	–	–	–	–

● Dosing required ○ Dosing optional

**Eco 40-60** - Test wash cycle in compliance with 2019/2014 regulation. The most efficient programme in terms of energy and water consumption for washing normally soiled cotton laundry. Display only: Spin speed values shown on the display can slightly differs from the values stated in the table

**For all Test Institutes**

Long wash cycle for cottons: set wash cycle Cotton with a temperature of 40°C. Synthetic program along: set wash cycle Synthetics with a temperature of 40°C. This data may differ in your home due to changing conditions in inlet water temperature, water pressure etc. Approximate programme duration values refer to the default setting of the programmes, without options. The values given for programmes other than the eco 40-60 programme are indicative only.

\* After programme end and spinning with maximum selectable spin speed, in default programme setting.

\*\* The duration of the programme is shown on the display.

The sensor technology adapts water, energy and programme duration to your wash load.

**PRODUCT DESCRIPTION**

- 1. Lid handle
- 2. Lid
- 3. Control panel
- 4. Detergent dispenser
- 5. Drum
- 6. Water filter - behind the cover
- 7. Mobility lever (depending on model)
- 8. Adjustable feet (x2)

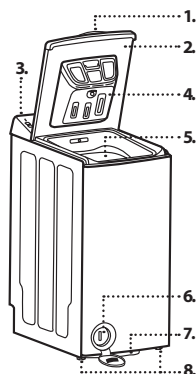

**DETERGENT DISPENSER**

**Main wash compartment**

Detergent for the main wash, stain remover or water softener.

**Prewash compartment**

Detergent for the prewash.

**Softener compartment**

Fabric softener. Liquid starch. Bleach.

**Pour in softener, starch or bleach solution only up to the "max" mark.**

**Release / Close button**

Press to remove tray for cleaning.

Press to close tray until you feel a click!

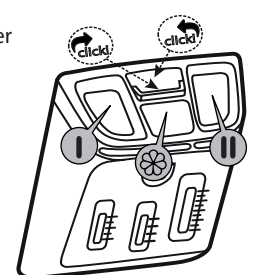

## PROGRAMMES

For choosing the appropriate programme for your kind of laundry, always respect the instructions on the care labels of the laundry. The value given in the tub symbol is the maximum temperature possible for washing the garment.



### Rapid 30'

For washing lightly soiled garments quickly. This cycle lasts only 30 minutes, saving time and energy.

### Eco 40-60

For washing normally soiled cotton garments declared to be washable at 40 °C or 60 °C, together in the same cycle. This is the standard cotton programme and the most efficient in terms of water and energy consumption.

! The cycle runs only at 40°C as per regulation.

### Aqua saver

Lightly soiled laundry made of synthetic fibres, or synthetics mixed with cotton garments. Saving programme with a very low water consumption. Use liquid detergent and the lowest recommended amount for 2.5kg laundry. Do not use softener.

### Colours

White and pastel shaded garments made of delicate fabrics. Gentle wash programme to avoid graying or yellowing of your laundry. Use heavy duty detergent, if necessary also stain removers or bleaches on oxygen basis. Do not use liquid detergent.

### Jeans

Turn garments inside-out before washing and use a liquid detergent.

### Hygiene

This program removes 99 % of bacteria while washing normally to heavily soiled bed linen, table linen and underwear, towels, shirts etc. made of cotton and linen.

### 20 °C

For washing lightly soiled cotton garments, at a temperature of 20 °C.

### Rinse & Spin

Separate rinse and intensive spin programme. For robust laundry.

### Spin

Spins the load then empties the water. For robust laundry.

### Wool

All wool garments can be washed using programme, "Wool" even those carrying the "hand-wash only" label. For best results, use special detergents and **do not exceed max kg declaration of laundry**.

### Delicates

For washing particularly delicate garments. Preferably turn garments inside out before washing.

### Synthetics

For washing soiled garments made from synthetic fibres (such as polyester, polyacrylic, viscose, etc.) or cotton/synthetic blends.

### Cotton

Normally to heavily soiled and robust cottons .

### Mixed

For washing lightly to normally soiled resilient garments in cotton, linen, synthetic fibres and mixed fibres.

## FIRST TIME USE

To remove any manufacturing debris select the "Cotton" programme at a temperature of 95°C. Pour a small quantity of detergent powder into the main wash compartment of the detergent dispenser (maximum 1/3 of the quantity the detergent manufacturer recommends for lightly soiled laundry). Start the programme **without adding any laundry**.

## DAILY USE

Prepare your laundry according to the recommendations in the "HINTS AND TIPS" section. Load the laundry, close the drum door and check that it is closed properly. Pour in the detergent and any additives. Observe the dosing recommendations on the detergent pack. Close the lid. Turn the programme selector to the desired programme and select any option if needed. The display shows the duration of the selected programme (in hours and minutes), and the indicator for the "Start/Pause" button flashes. The temperature and spin speed can be changed by pressing the "Temperature" button or the "Spin" button. Open the tap and press the "Start/Pause" button to start the wash cycle. The "Start/Pause" indicator will light up and the door will be locked. Due to variations in load and temperature of inlet water, the remaining time is newly calculated in certain programme phases. If this is the case, an animation,  appears on the time display.

## PAUSE OR CHANGE A RUNNING PROGRAMME

To pause the wash cycle, press the "Start/Pause" button, the indicator light blinks. Select any new programme, temperature, options or spin speed if you wish to change those settings. Press the "Start/Pause" button again to start the wash cycle from the point at which it was interrupted. Do not add detergent for this programme.

## DOOR OPEN INDICATOR

Before starting and after the end of a programme, the "Door open" indicator lights to show that the lid can be opened. As long as a wash programme is running, the lid remains locked and must on no account be forced open. In case you have an urgent need to open it during a running programme, for example to add more laundry, or to remove laundry which was loaded by mistake, press the "Start/Pause" button. If the temperature is not too high, the "Door open" indicator light turns on. It may last a while until you can open the lid. Press "Start/Pause" to proceed with the programme again.

## PROGRAMME END

The "Door open" indicator lights up and the display shows **End**. Turn the programme selector to the "O" position and close the water tap. Open the lid and drum and unload the machine. Leave the Lid open for some time to allow the interior of the machine to dry. After about a quarter of an hour, the washing machine will switch off completely to save energy. To cancel a running programme before the end of cycle, press the "Reset/Drain" button for at least 3 seconds. The water is drained out. It may last a while until you can open the lid.

## OPTIONS

! When the combination of programme and additional option(s) is not possible, the indication lights switch off automatically.

! Unsuitable combinations of options are deselected automatically.

### Colours 15°

Saves energy used for water heating while maintaining a good wash result. Supports colour maintenance when washing coloured laundry. Recommendable for lightly soiled laundry without stains. Make sure that your detergent is suitable for cold wash temperatures.

### FreshTouch

Select this option if you cannot unload the laundry soon after programme end, or if you tend to forget the laundry in your washing machine. It will help to keep your laundry fresh. The washing machine will start to tumble the laundry periodically after programme end. The light of the "FreshTouch" button will blink while this function is active, and the display will show an animation. The periodic tumbling will last up to approximately 6 hours after the end of your wash programme, and you can stop it at any time by pressing the "FreshTouch" button. It will last a while until you can open the door. After the "FreshTouch" period has run out, the display indicates **End**.

### Temperature

Every programme has a predefined temperature. If you want to change the temperature, press the "Temperature" button. The value appears on the display.

### Start delay

To set the selected programme to start at a later time, press the "Start delay" button to set the desired delay time. The lamp for the "Start delay" option button lights up, and it goes off when the programme starts. Once having pressed the "Start/Pause" button, the countdown of the time delay begins. Number of hours pre-selected can be reduced by pressing the "Start delay" button again. **Do not use liquid detergent when activating this option.** To cancel the "Start delay" turn the programme selector to another position.

### Rapid

Enables quicker washing by shortening the programme duration. Recommendable for small loads or only lightly soiled laundry.

### Prewash

Only for heavily soiled loads (for example sand, granular dirt). Increases the cycle time by approximately 15 min. Do not use liquid detergent for the main wash when activating the Prewash option.

### Soil Level

It is an option working on 3 different levels (lightly soiled, normally soiled, heavily soiled) that are specially designed to set the right washing action, depending on your cleaning needs:

**Heavily soiled **: this option is designed for high levels of dirtiness, removing most stubborn stains.

**Normally soiled **: this option is designed to remove everyday stains.

**Lightly soiled **: this option is designed to remove lightly soiled stains.

### Spin

Every programme has a predefined spin speed. If you want to change the spin speed, press the "Spin" button. If spin speed "0" is selected, the final spinning is cancelled but intermediate spin peaks remain during the rinse. The water is drained out only.

**CHILD LOCK**  3 sec

You can lock the buttons of the control panel against improper use (e.g. by children). Press both of the child lock buttons simultaneously and hold them for at least 3 seconds. The key symbol  on the display lights up. To unlock the buttons again proceed in the same way.

**BLEACHING**

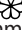
Wash your laundry in the desired programme, Cotton or Synthetics, adding an appropriate amount of chlorine bleach to the Softener  chamber (close the lid carefully). Immediately after the end of the programme, turn the "Programme selector" and start the desired programme again to eliminate any residual bleach smell; if you want, you can add softener. **Never put both chlorine bleach and softener into the softener chamber at the same time.**

**ECO MONITOR**

The "Eco monitor" gives you a rough feedback about the power consumption of the programme setting you selected. As soon as you turn the programme selector to any programme, the "Eco monitor" is on. The indicator on the left is to show that the "Eco monitor" is active. The four indicators next to it show the degree of consumption: the less power your programme setting is forecasted to consume, the less indicators will light up. This depends on the programme, temperature and options selected, and also on the size of the wash load. For that reason, the forecasted degree of power consumption may adapt when the washing machine detects the wash load.

**HINTS AND TIPS****Sort your laundry according to**

Type of fabric/care label (cotton, mixed fibres, synthetics, wool, handwash items). Colour (separate coloured and white items, wash new coloured items separately). Delicates (wash small items – like nylon stockings – and items with hooks – like bras – in a cloth bag or pillow case with zip).

**Empty all pockets**

Objects like coins or lighters can damage your laundry as well as the drum.

**Appliance interior**

If you never or seldom wash your laundry at 95°C, we recommend to occasionally run a 95°C programme without laundry, adding a small amount of detergent, to keep the interior of the appliance clean.

**Follow the dosage recommendation / additives**

It optimizes the cleaning result, it avoids irritating residues of surplus detergent in your laundry and it saves money by avoiding waste of surplus detergent

**Use low temperature and longer duration**

The most efficient programmes in terms of energy consumption are generally those that perform at lower temperatures and longer duration.

**Observe the load sizes**

Load your washing machine up to the capacity indicated in the "PROGRAMME CHART" table to save water and energy.

**Noise and remaining moisture content**

They are influenced by the spinning speed: the higher the spinning speed in the spinning phase, the higher the noise and the lower the remaining moisture content.

**CLEANING & MAINTENANCE**

**For any cleaning and maintenance, switch off and unplug the washing machine. Do not use flammable fluids to clean the washing machine. Clean and maintain your washing machine periodically (at least 4 times per year).**

**Cleaning the outside of the washing machine**

Use a soft damp cloth to clean the outer parts of the washing machine. Do not use glass or general purpose cleaners, scouring powder or similar to clean the control panel – these substances might damage the printing.

**Detergent dispenser**

**Clean regularly, at least three or four times a year, to prevent detergent build-up:**

Press the release button  to release the detergent dispenser and remove it. A small quantity of water can remain in the dispenser, thus you should carry it in an upright position. Wash the dispenser using running water. Remove the siphon cap on the back of the dispenser for cleaning. Replace the siphon cap in the dispenser (if removed) Reinstall the dispenser by locating the dispenser's bottom tabs into the appropriate openings on the lid, and by pushing the dispenser against the lid until it locks into place.

Press on the close button  until you feel a click!

**Make sure that the detergent dispenser is correctly reinstalled.**

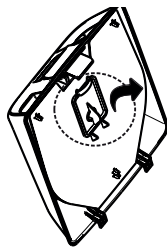
**Checking the water supply hose**

Check the inlet hose regularly for brittleness and cracks. If damaged, replace it by a new hose available through our After-Sales Service or your specialist dealer. Depending on the hose type: If the inlet hose has a transparent coating, periodically check if the colour intensifies locally. If yes, the hose may have a leak and should be replaced. For water stop hoses  (if available): check the small safety valve inspection window (see arrow). If it is red, the water stop function was triggered, and the hose must be replaced by a new one. For unscrewing this hose, press the release button (if available) while unscrewing the hose.

**Cleaning the mesh filters in the water supply hose**

**Check and clean regularly (at least two or three times a year).**

Close the tap and loosen the inlet hose on the tap. Clean the internal mesh filter and screw the water inlet hose back onto the tap. Now unscrew the inlet hose on the rear of the washing machine. Pull off the mesh filter from the washing machine connection with universal pliers and clean it. Refit the mesh filter and screw the inlet hose on again. Turn on the tap and ensure that the connections are completely water-tight.

**Cleaning the water filter / draining residual water**

**The washing machine is provided with a self-cleaning pump. The filter keeps objects like buttons, coins, safetypins etc. which have been left in the laundry. If you used a hot wash programme, wait until the water has cooled down before draining any water. Clean the water filter regularly, to avoid that the water cannot drain after the wash due to obstruction of the filter. If the water cannot drain, the indicator indicates that the water filter may be clogged.**

Open the filter cover with a coin. Place a broad, flat container beneath the water filter, to collect the drain water. Slowly turn the filter counterclockwise until water flows out. Let the water flow out, without removing the filter. When the container is full, close the water filter by turning it in clockwise. Empty the container. Repeat this procedure until all the water has drained. Lay a cotton cloth beneath the water filter, which can absorb a small amount of rest water. Then remove the water filter by turning it out anti clockwise. Clean the water filter (remove residues in the filter and clean it under running water) and the filter chamber. Make sure the pump impeller (in the housing behind the filter) is not obstructed. Insert the water filter and close the filter cover. Reinsert the water filter again by turning it in clockwise direction. Make sure to turn it in as far as it goes. To test water tightness of the water filter, you can pour about 1 liter of water into the drum and check that water does not leak from the filter. Then close the filter cover.

**Lid seal**

Check the condition of the lid seal periodically and clean it from time to time with a damp cloth.

**Recovering an object that falls between the drum and the tub**

If an object accidentally falls between the drum and the tub, you can recover it thanks to one of the removable drum lifters.



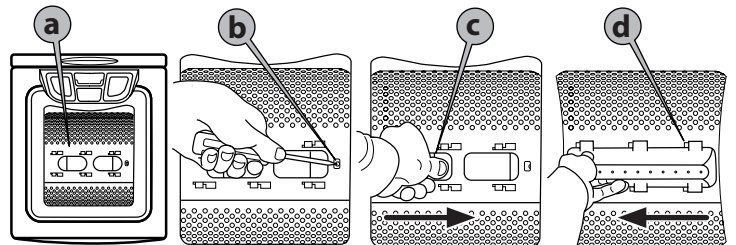



Unplug the washing machine. Remove the laundry from the drum. Close the drum flaps and turn the drum a half-turn (picture a). Using a screw-driver press on the plastic end, while sliding the lifter from left to right (picture b, c) by hand it will fall into the drum. Open the drum. You can recover the object through the hole in the drum. Refit the lifter from inside the drum: Position the plastic tip above the hole on the right side of the drum (picture d). Then slide the plastic lifter from right to left until it clips. Close the drum flaps again, turn the drum through half a turn and check the positioning of the blade at all its anchorage points. Plug the washing machine in again.

**TRANSPORT AND HANDLING**

Pull out the mains plug, and close the water tap. Disconnect the inlet hose from the water tap, and remove the drain hose from your draining point. Remove all rest water from the hoses and washing machine and fix hoses so that they cannot get damaged during transport. To facilitate moving the machine, pull the mobility lever situated at the bottom front (if available on your model) out a little by hand. Pull the washing machine out to the stop with the foot. Afterwards push the mobility lever back into the original stable position. Refit the transport bracket. Follow the instructions for removing the transport bracket in the INSTALATION GUIDE in reverse order.

## TROUBLESHOOTING

The washing machine may sometimes not work properly for certain reasons. Before calling the After-sales service, it is recommended to check to see if the problem can be easily resolved using the following list.

Anomalies:	Possible causes / Solution:
<b>The washing machine does not turn on and/ or programme does not start</b>	<ul style="list-style-type: none"> <li>The plug is not inserted into the electrical outlet, or not enough to make contact.</li> <li>There has been a power failure.</li> <li>Lid is not properly closed.</li> <li>The "Child lock"  3sec function has been activated (if available).</li> <li>The washing machine switched off automatically to save energy, before programme start or after programme end. To switch on the washing machine, turn the programme selector first to "Off/O" and then to the desired programme again.</li> </ul>
<b>The wash cycle does not start.</b>	<ul style="list-style-type: none"> <li>The "Start/Pause"  button has not been pressed.</li> <li>The water tap is not open.</li> <li>A "Start delay" has been set.</li> </ul>
<b>Appliance stops during the programme, and the "Start/Pause" light blinks</b>	<ul style="list-style-type: none"> <li>"Rinse hold" option is activated (if available).</li> <li>Programme has been changed - re-select desired programme and press "Start/Pause" .</li> </ul>
<b>Appliance vibrates</b>	<ul style="list-style-type: none"> <li>The washing machine is not level.</li> <li>The transport bracket has not been removed; before using the washing machine, the transport bracket must be removed.</li> </ul>
<b>Final spin results are poor. The laundry is still very wet. "Spin/Drain" indicator blinks, or the spin speed on the display blinks, or the spin speed indicator blinks after the end of the programme - depending on the model</b>	<ul style="list-style-type: none"> <li>Unbalance of the laundry load during spinning prevented the spin phase to avoid damages on the washing machine. This is why the laundry is still very wet. Reason for unbalance can be: small laundry loads (consisting of only few quite big or absorbent items, e.g. towels), or big/ heavy laundry items.</li> <li>If possible avoid small laundry loads.</li> <li>"Spin" button has been set to a low spin speed.</li> </ul>
<b>The machine is indicating an error code (e.g. F-02, F-..) and/or "Service"  indicator lights up</b>	<ul style="list-style-type: none"> <li>Shut off the machine, disconnect the plug from the outlet, and wait about 1 minute before turning it back on.</li> <li>If the problem persists, call the After-sales service.</li> </ul>
<b>"Clean pump"  indicator lights up</b>	<ul style="list-style-type: none"> <li>Waste water is not pumped out.</li> <li>Clean the water filter</li> </ul>
<b>"Water tap closed"  indicator lights up</b>	<ul style="list-style-type: none"> <li>Appliance has no or insufficient water supply.</li> </ul>
<b>"Detergent over dosage"  indicator lights up (if available)</b>	<ul style="list-style-type: none"> <li>The symbol will light up at the end of the programme if you used too much detergent.</li> <li>Too much foam is formed.</li> <li>The detergent is not compatible with the washing machine (it must bear the wording "for washing machines", "for hand washing and washing machines", or something similar).</li> </ul>

### Policies, standard documentation, ordering of spare parts and additional product information can be found by

The model information can be retrieved using the QR-Code reported in the energy label. The label also includes the model identifier that can be used to consult the portal of the registry at <https://eprel.ec.europa.eu>

Alternatively, **contact our After-Sales Service** (See phone number in the warranty booklet). When contacting our After-sales Service, please state the codes provided on your product's identification plate.

