

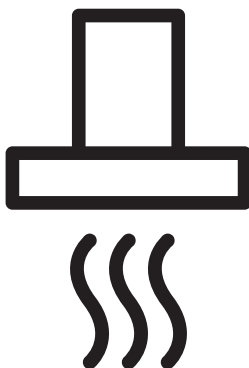

## Cooker Hood

User Manual



HCA93640SS

EN



01M-8895813200-5221-03

# CONTENTS

---

## **1 Important safety and environmental instructions 4**

1.1 General safety .....	4
1.2 Compliance with the WEEE Directive and Disposing of the Waste Product:.....	7
1.3 Compliance with RoHS Directive .....	7
1.4 Package Information .....	7

## **2 General appearance 8**

2.1 Overview .....	8
2.2 Technical Data .....	8

## **3 Operation of the appliance 9**

3.1 Controlling the Appliance .....	9
3.2 Energy efficient usage .....	9
3.3 Operating the hood .....	9
3.4 Automatic stop .....	9
3.5 Replacement of Lamp .....	9
3.6 Operation with chimney connection .....	10
3.7 Operation without chimney connection .....	10

## **4 Cleaing and maintenance 11**

4.1 Cleaning of the grease filter .....	11
4.2 Replacement of Carbon Filters .....	11

## **5 Installation of appliance 12**

5.1 Position of the appliance .....	12
5.2 Installation Accessories .....	12
5.3 Wall Mounting.....	12
5.4 Preparing the Appliance .....	13
5.5 Connecting to Chimney .....	14
5.6 Installation of the Hood to the Chimney ....	14

## **6 Troubleshooting 15**

---

# Please read this user manual first!

Dear Valued Customer,

Thank you for preferring this Beko appliance. We hope that you get the best results from your appliance which has been manufactured with high quality and state-of-the-art technology. For this reason, please read this entire user manual and all other accompanying documents carefully before using the appliance and keep it as a reference for future use. If you handover the appliance to someone else, give the user manual as well. Follow the instructions by paying attention to all the information and warnings in the user manual.

Remember that this user manual may also apply to other models. Differences between models are explicitly described in the manual.

## Meanings of the Symbols

Following symbols are used in various sections of this user manual:



Important information and useful hints about usage.



**WARNING:** Warnings against dangerous situations concerning the security of life and property.



**WARNING:** Warning for danger of fire.



**WARNING:** Warning for electric shock.



This appliance has been produced in environmentally friendly facilities without harming the nature.

---

# 1 Important safety and environmental instructions

## 1.1 General safety

**Important Safety Instructions Read Carefully And Keep For Future Reference** This section contains safety instructions that will help protect from risk of fire, electric shock, exposure to leak microwave energy, personal injury or property damage. Failure to follow these instructions shall void any warranty.

- Beko products comply with the applicable safety standards; therefore, in case of any damage on the appliance or power cable, it should be repaired or replaced by the dealer, service center or a specialist and authorized service alike to avoid any danger. Faulty or unqualified repair work may be dangerous and cause risk to the user.
- This appliance is intended to be used in household and similar applications such as:
  - Staff kitchen areas in shops, offices and other working environments;
  - Farm houses
  - By clients in hotels, and other residential type environments;
  - Bed and Breakfast type environments.
- Operate the appliance for its intended purpose only as described in this manual.
- The manufacturer cannot be held liable for damages resulting from improper installation or misuse of the product.
- This appliance can be used by children aged from 8 years and above and persons with reduced physical, sensory or mental capabilities or lack of experience and knowledge if they have been given supervision or instruction concerning use of the appliance in a safe way and understand the hazards involved.
- Children shall not be allowed play with the appliance. Cleaning and user maintenance shall not be made by children without supervision.

# 1 Important safety and environmental instructions

- The minimum distance between the supporting surface for the cooking vessels on the hob and the lowest part of your product must be at least 65 cm.
  - If the instructions for installation for the gas hob specify a greater distance, this has to be taken into account.
  - Make sure that your mains power supply complies with the information supplied on the rating plate of the appliance.
  - Never use the appliance if the power cable or the appliance itself is damaged.
  - Prevent damage to the power cable by not squeezing, bending, or rubbing it on sharp edges. Keep the power cable away from hot surfaces and naked flame.
  - Use the appliance with a grounded outlet only.
- WARNING:** Do not connect the appliance to the mains until the installation is fully complete.
- Place the appliance in a way so that the plug is always accessible.
  - Do not touch the lamps if they have operated for a long time. They can burn your hands since they will be hot.
  - Follow the regulations set out by competent authorities on discharge of the exhaust air (this warning is not applicable for use without flue).
  - Operate your appliance after putting a pot, pan etc. on the hob. Otherwise, high heat may cause deformation in some parts of your product.
  - Turn off the hob before taking the pot, pan etc. from it.
  - Do not leave hot oil on the hob. Pans with hot oil may cause self combustion.
  - Pay attention to your curtains and covers since oil may catch fire while cooking food such as fries.
  - Grease filter must be cleaned at least monthly. Carbon filter must be replaced at least every 3 months.

# 1 Important safety and environmental instructions

- Product shall be cleaned accordance with user manual. If cleaning was not carried out in accordance with user manual, there may be fire risk.
  - Do not use non-fire-resistant filtering materials instead of the current filter.
  - Only use the original parts or parts recommended by the manufacturer.
  - Do not operate the product without the filter and do not remove the filters while the product is running.
  - In the event of be started any flame, de-energize your product and cooking appliances.
  - In the event of be started any flame, cover the flame and never use water to extinguish.
  - Unplug the appliance before each cleaning and when the appliance is not in use.
  - The negative pressure in the environment should not exceed 4 Pa (4x10 bar) while the hood for electric hob and appliances running on another type of energy but electricity operate simultaneously.
  - In the environment where the appliance is being used, the exhaust of devices running on fuel oil or gas, such as room heater must be absolutely isolated or device must be hermetical type.
  - When connecting the flue, use pipes with a diameter of 120 or 150 mm. Pipe connection must be as short as possible and have as few elbows as possible.
  - Danger of choking! Keep all the packaging materials away from children.
- CAUTION:** Accessible parts may become hot when used with cooking appliances.
- The product outlet must not be connected to air channels that include other smoke.
  - The ventilation in the room may be insufficient when the hood for electric hob is used simultaneously with the devices operating on gas or other fuels (this may not apply to appliances that only discharge the air back into the room).

# 1 Important safety and environmental instructions

- Objects placed on the product may fall. Do not place any objects on the product.
- Do not flambe under the your product.

**WARNING:** Before installing the Hood, remove the protective films.

- Never leave high naked flames under the hood when it is in operation
- Deep fat fryers must be continuously monitored during use: overheated oil can burst into flames.

## 1.2 Compliance with the WEEE Directive and Disposing of the Waste Product:

This product complies with EU WEEE Directive (2012/19/EU). This product bears a classification symbol for waste electrical and electronic equipment (WEEE).

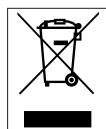

This symbol indicates that this product shall not be disposed with other household wastes at the end of its service life. Used device must be returned to official collection point for recycling

of electrical and electronic devices. To find these collection systems please contact to your local authorities or retailer where the product was purchased. Each household performs important role in recovering and recycling of old appliance. Appropriate disposal of used appliance helps prevent potential negative consequences for the environment and human health.

## 1.3 Compliance with RoHS Directive

The product you have purchased complies with EU RoHS Directive (2011/65/EU). It does not contain harmful and prohibited materials specified in the Directive.

## 1.4 Package Information



Packaging materials of the product are manufactured from recyclable materials in accordance with our National Environment Regulations. Do not dispose of the packaging materials together with the domestic or other wastes. Take them to the packaging material collection points designated by the local authorities.

## 2 General appearance

### 2.1 Overview

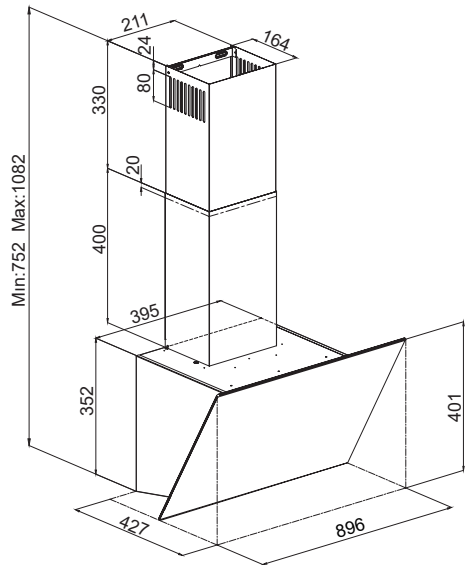
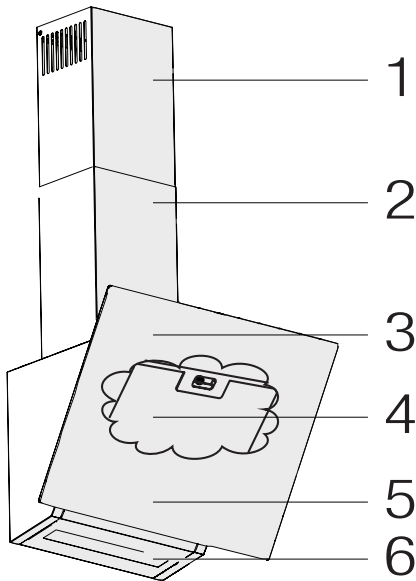

1. Inner chimney
2. Outer chimney
3. Glass cover
4. Grease filter (Behind glass cover)
5. Control panel
6. Lighting





### 2.2 Technical Data

<b>Model</b>	HCA93640SS
<b>Supply voltage &amp; Frequency</b>	220-240V ~ 50 Hz
<b>Lamp Power</b>	6,7 W
<b>Motor Power</b>	275 W
<b>Flow rate – 3. Level</b>	574 m³/h
<b>Flow rate - High Level</b>	756 m³/h
<b>Insulation Class of Motor</b>	Class F
<b>Insulation Class</b>	Class I

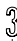

## 3 Operation of the appliance

### 3.1 Controlling the Appliance

				
A	B	C	D	E
KEY	FUNCTION			
<b>A : Light On / Off</b>	You may illuminate the cooking area by pressing this button.			
<b>B : 1. Stage Button</b>	The hood operates in 1st speed level by pressing this button. Press this button again to switch off the appliance.			
<b>C : 2. Stage Button</b>	The hood operates in 2nd speed level by pressing this button. The display and hood turn off when you press this button again to switch off the appliance.			
<b>D : 3rd Stage Button</b>	The hood operates in 3rd speed level by pressing this button. The display and hood turn off when you press this button again to switch off the appliance			
<b>E : High Level Button</b>	When the appliance is switched to high level in use, the high level light indicator will blink. This indicates that the high level ventilation mode is active. Appliance will operate 7 minutes in this mode and will switch to one lower level after 7 minutes and will continue to operate at the switched mode.			

### 3.2 Energy efficient usage

- When using your appliance, adjust the speed settings according to vapour and odour intensity, in order to save energy.
- Use low speeds (1-2) under normal conditions, and high speed (3) for intense odour and vapour.
- The lamps on the hood are placed for illuminating the cooking area.
- Using them for environmental lighting shall cause unnecessary energy expenditure and insufficient lighting.

### 3.3 Operating the hood

- Your appliance contains a motor that has various speeds.
- For better performance, we recommend using low speeds under normal conditions and high speeds in cases of strong odours and intense vapour.
- You can start your appliance by pressing on the desired speed setting button. (B, C, D, E).
- You may illuminate the cooking area by pressing the lamp (A).

### 3.4 Automatic stop

Your appliance has Automatic Stop feature, enabling it to ventilate for a bit more and remove the unwanted odours and vapour inside the environment and turn off automatically after the cooking is done. To enable Automatic Stop feature, press the any speed stage button (B, C, D) on the control panel for longer than 2 seconds; the 15-minute timer function shall be activated. When the automatic stop feature is active, pressing the same speed button shall disable the automatic stop function and the appliance's motor shall stop. This feature is disabled when you switch between different speed stages. If you want the appliance to stop automatically, you need to enable the automatic stop feature again.

### 3.5 Replacement of Lamp

<b>Bulb</b>	
<b>Bulb Power</b>	10.1 W
<b>Holder / Socket</b>	LED bar
<b>Bulb Voltage</b>	220 - 240 V
<b>Size</b>	294 mm

## 3 Operation of the appliance

<b>ILCOS Code</b>	DBL-3/840-220/240- FP-12/294
<b>Luminous flux</b>	638 lm
<b>Correlated colour temperature</b>	4000 K

This product contains a light source of energy efficiency class "F".

### 3.6 Operation with chimney connection

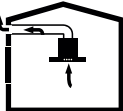
-  Vapour is extracted through the flue duct, which is fastened to the connection head on the hood.
- The diameter of the flue duct must be the same as the connection ring. In horizontal settings, the pipe has to have a slight upward slope (around 10°) so that the air can exit the room easily.

### 3.7 Operation without chimney connection

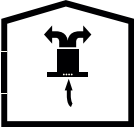
-  Air is filtered through the carbon filter and recirculated in the room. Carbon filter is used when it is impossible to use a flue in the house.
- In flueless use, remove the flaps inside the flue adapter.
- Remove the Grease filter. To install the carbon filter, fit the filter to the tabs by centring it on the plastic piece on both sides of the fan body. tighten it by turning right or left.
- Replace Grease filter.

## 4 Cleaning and maintenance



Before cleaning and maintenance, unplug the product or turn off the switch.

### 4.1 Cleaning of the grease filter

This filter retains the oil particles in the air. Grease filter may change colour as they are washed; this is normal and does not require replacing your grease filter.

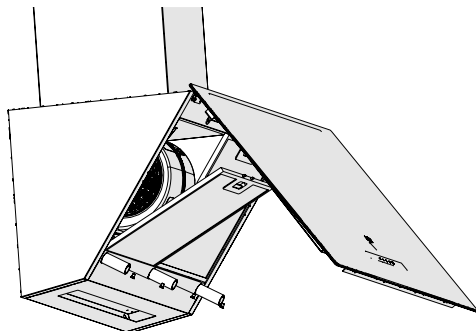

- Push the grease filter lock forward.
- Then pull it slightly down and pull it out. Otherwise, you can bend the filter. Wash and rinse Grease filter with liquid detergent and replace grease filter to their sockets by carrying out the steps specified above in reverse order. This filter retains the oil particles in the air.



You may wash your grease filter in the dishwasher.



**CAUTION:** In case of normal use, clean your filter once in a month.

### 4.2 Replacement of Carbon Filters

Odour removing filters contain charcoal (Active carbon). Grease filter must be installed in the product, regardless of whether or not carbon filters are used.

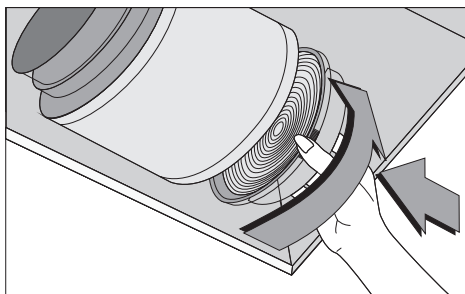

- The appliance you have purchased is appropriate for use with carbon filters.
- Remove the grease filter.
- To remove the carbon filter, remove the carbon filter from its housing by rotating it counter-clockwise from the tab.
- Install the new carbon filter.
- Install the grease filter.

#### CAUTION



- Carbon filter shall never be washed.
- Replace carbon filters once every 3 months.
- You can obtain the carbon filter from the authorized services.

## 5 Installation of appliance



**WARNING:** Before starting the installation, read the safety information on user manual.



**WARNING:** Failure to install with screws and stabilizers in accordance with these instructions may result in electric shock.

For the installation of the hood, please contact the nearest Authorized Service.

It is the customer's responsibility to prepare the location and electrical installation of the hood.

### 5.1 Position of the appliance

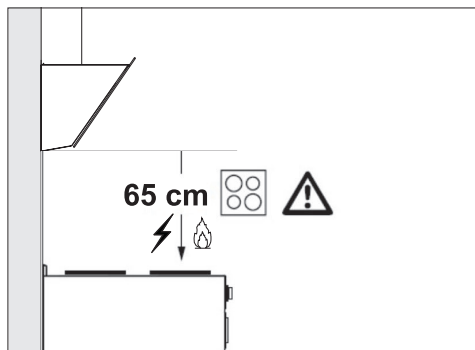

- Distance between the cooker and the cooker hood must be considered prior to assembly. This distance should be 65 cm.
- Distance must be measured from the surface of grate for gas cookers,
- from surface of glass for electric cookers.

### 5.2 Installation Accessories

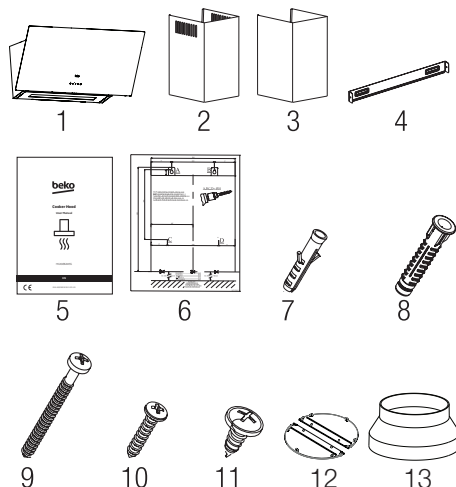

1. Product
2. Inner Chimney
3. Outer Chimney
4. Chimney Connection Plate
5. User Manual
6. Assembly Template
7. 2x Ø6mm Plastic Dowel
8. 4x Ø8mm Plastic Dowel
9. 4x 4.8x50 Wall Hanger Screw
10. 2x 3.9x22 Flue Connection Plate Screw
11. 4x 3.5x9.5 Flue Connection Screw
12. NRV Flue Flap (On the Product)
13. Ø150 / 120mm Plastic Chimney Adapter

The information required to make the location suitable for the installation of the hood is given below.

### 5.3 Wall Mounting



Use protective gloves and glasses while performing drilling and cutting operations.

## 5 Installation of appliance

- Wall must be flat, straight and have the sufficient bearing capacity.
- Depth of drilling holes must comply with the length of bolts.
- The bolts and dowels provided are suitable for brick walls. For other construction material (e.g. drywall, plate, porous concrete), suitable fixing dowels and nuts shall be used.

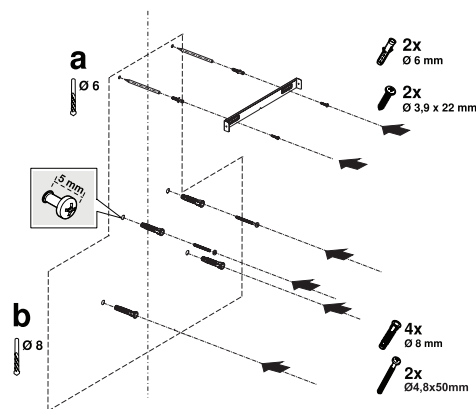

**Figure 1**



**CAUTION:** Before drilling, ensure that there are no power, gas or water pipes in the close proximity of the drilling locations.

- Draw a central point line on the wall, from the ceiling to the lower side of the hood (Figure 1).
- There is a notch in the middle of the flue connection plate. Place the central point of this notch, which is found on the flue connection plate, on the vertical line you drew on the wall. Align it vertically and use a pen to mark the holes to which the flue connection plate will be installed (Figure 1/a).
- Drill the marked points with a Ø6mm drill and insert 2x Ø6mm plastic pins in these holes (Figure 1/a).
- Fix the flue connection plate to the wall with 3.9x22 screws (Figure 1/a).

- To drill hang holes for the hood, stick the installation template to the surface to which the product will be installed and mark the installation holes (Figure 1/b).
- Drill hang holes with Ø8mm drill and insert the pins (Figure 1/b).
- Insert 2x4.8x50 hang screws, ensuring that there is a 5 mm space between the screw head and the wall (Figure 1/b).

### 5.4 Preparing the Appliance

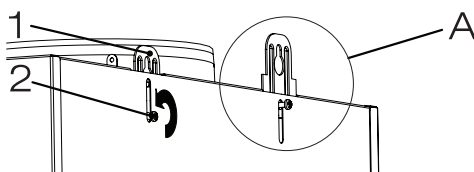

**Figure 2**

1. Hanger Plate

2. Hanging Plate Connection Screw

To mount the device on the wall, loosen the screws of the hanger plates attached on the motor cabin, pull upwards and then fix them again (Figure 1/A).

Open the side suction glass of the device and remove the aluminum oil filter.

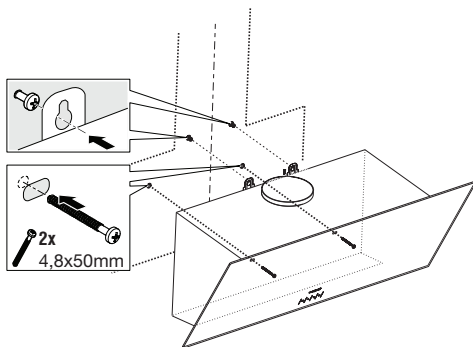

**Figure 3**

Holding the device by its body, attach it to the hanger screws you have previously screwed to the wall and tighten the hanger screws well (Figure 3).

## 5 Installation of appliance

Secure it to the wall with two 4.8x50 screws from the mounting holes on the interior of the device (Figure 3).

### 5.5 Connecting to Chimney

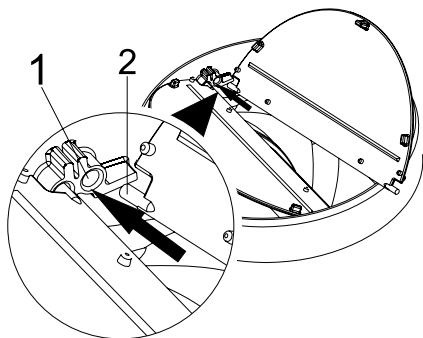

**Figure 4**

1. Flap Pin Socket

2. Flap Pin

Insert the plastic pin (area number 4/2) on the flap into the pin socket (area number 4/1) located in the motor outlet. Then, to install the other pin on the flap, gently flex the plug and insert it into the other pin socket (Figure 4).

If you are going to use the Ø 120/150 mm plastic Chimney adapter, connect one end of the pipe to this adapter, if you are not going to use it, to the direct output on the product. Connect the other end of the pipe to your chimney. Check that these two connections are tight enough so they will not come out when the appliance runs on full power. Ensure that the flaps inside the chimney work when tightened with clamp. Connect the chimney connection duct outside the adapter (Figure 5/a). If the connection duct is fitted inside the adapter, suction of air shall not occur as the Chimney flap that prevents the return of air will remain closed (Figure 5/b). The length of the pipe connection as well as the number of elbows must be as minimum as possible.

A : Chimney exit pipe

B : Chimney Clamps

C : Plastic Chimney

The valves are closed then the appliance is not operating and prevent possible outside odour and dust from entering inside.

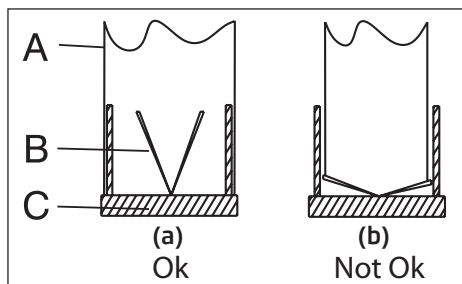

**Figure 5**

### 5.6 Installation of the Hood to the Chimney

Before starting the flue assembly, make the electrical connection of your product. Thread the plate chimneys Around the body. Screw the outer flue to the outer flue connection plates on the engine cabin (Figure 6). Extend the inner chimney from the upper outer edges to the chimney mounting plate fixed to the wall and screw it on.

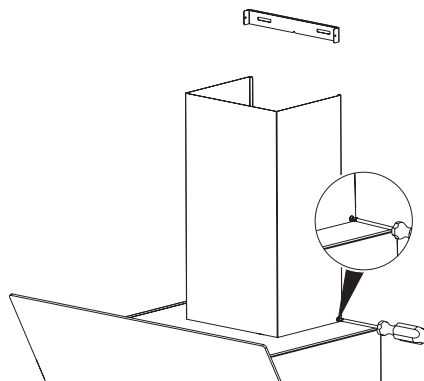

**Figure 6**

## 6 Troubleshooting

Troubleshooting	Root cause	Help
Appliance is not working.	Check your fuses.	Fuse may be blown, inspect and restore it.
Appliance is not working.	Check the electrical connection.	Mains voltage shall be between 220 and 240 V.
Appliance is not working.	Check the electrical connection.	Check if other appliance in your kitchen operate.
Illumination light does not operate.	Check the electrical connection.	Mains voltage shall be between 220 and 240 V.
Illumination light does not operate.	Inspect the lamp switch.	Lamp switch shall be at "on" position.
Illumination light does not operate.	Inspect the lamps.	The lamps of the appliance shall illuminate.
Air inlet of the appliance is inadequate.	Inspect the aluminium filter.	Under normal operating conditions, Grease filter shall be cleaned at least once in a month.
Air inlet of the appliance is inadequate.	Check the air discharge chimney.	The air discharge chimney shall be at "on" position.
Air inlet of the appliance is inadequate.	Inspect the carbon filter.	The filters of the appliances with carbon filters shall be replaced once in every 3 months under normal conditions.

Arçelik A.Ş.  
Karaağaç Caddesi No: 2-6, 34445,  
Sütlüce, İstanbul, Türkiye

[www.beko.com](http://www.beko.com)