

## Please read this manual first!

Dear Customer,

Thank you for preferring this Beko product. We hope that you get the best results from your product which has been manufactured with high quality and state-of-the-art technology. Therefore, please read this user manual and all other accompanying documents carefully before using the product and keep it as a reference for future use. If you handover the product to someone else, give the user manual as well. Follow all warnings and information in the user manual.

## Meanings of the symbols

Following symbols are used in the various sections of this manual:



Important information and useful hints about usage.



**WARNING:** Warnings against dangerous situations concerning the security of life and property.



**WARNING:** Warning for hot surfaces.



**WARNING:** Do not immerse the appliance, power cord or power plug in water or in other liquids.



**WARNING:** Risk of burning and scalding due to steam.



**WARNING:** Risk of burning and scalding due to steam.

# 1 Important safety and environmental instructions

This section contains safety instructions that will help protect from risk of personal injury or material damage.

Failure to follow these instructions invalidates the granted warranty.

## 1.1 General safety

Please pay attention to the cleaning and maintenance for the product in following instruction

- This appliance complies with the international standards.
- This appliance is intended to be used in household and similar applications such as:
  - Staff kitchen areas in shops, offices and other working environments;
  - Farm houses
  - By clients in hotels, and other residential type environments;
  - Bed and Breakfast type environments.
- The appliance is not suitable for outdoor use.
- This appliance can be used the children who are at the age of 8 and above and by people who have limited physical, sensory or mental capacity or who do not have knowledge and experience, provided that they are supervised or they understand the instructions with regard to safe use of the product and potential dangers. Children should not play with the appliance. Cleaning and user maintenance procedures should not be performed by children unless they are supervised by an older person.
- When the appliance is in use or left to cool down, keep the appliance and power cable out of reach of children under 8 years old.
- Do not leave the appliance unattended while it is plugged in.
- Unplug the appliance before filling the water reservoir with water.
- Do not open the water refill hole during usage.

# 1 Important safety and environmental instructions

- The iron must be used and rested on a flat, stable surface.
- When the appliance is placed on its base plate, ensure that the surface beneath the plate is level.
- Keep your device in a vertical position or place on the iron dock when you are not using or having a pause during ironing.
- If the appliance is dropped or leaks water or has other failures, contact the authorised service. Do not use the appliance until it is repaired.
- Only use the original parts or parts recommended by the manufacturer.
- Before you start calc cleaning, - make sure the calc box on the backside of the steam iron station is empty.
- Do not dismantle the appliance.
- Your mains power supply should comply with the information supplied on the rating plate of the appliance.
- The mains supply of the appliance should be secured with a 16 A fuse minimum.
- Use the appliance with a grounded outlet.
- Do not use the appliance with an extension cable.
- Do not pull the power cable when unplugging the appliance.
- If the power cable is damaged, it should be repaired or replaced by the dealer, service center, or a specialised and authorised service with similar qualifications.
- Unplug the appliance before cleaning.
- Do not wrap the cable around the appliance.
- Do not touch the appliance or its plug with damp or wet hands when the appliance is plugged in.
- The soleplate and the steam station surface may get overheated. Contact with hot surfaces may cause burns.

# 1 Important safety and environmental instructions

- Do not use the appliance in or near the areas where combustible or inflammable places and materials exist.
- If you keep the packaging materials, store them out of the reach of children.
- Do not remove calc box from its place during the transfer of water to the container or until you hear an audible warning.
- The filling, or decalcifying, or rinsing, or inspection apertures that are under pressure, shall not be opened during use.

## 1.2 Compliance with WEEE Directive and Disposing of the Waste Product

This product complies with EU WEEE Directive (2012/19/EU). This product bears a classification symbol for waste electrical and electronic equipment (WEEE).



This symbol indicates that this product shall not be disposed with other household wastes at the end of its service life. Used device must be returned to official collection point for recycling of electrical and electronic devices. To find these collection systems please contact to your local authorities or retailer where the product was purchased. Each household performs important role in recovering and recycling of old appliance. Appropriate disposal of used appliance helps pre-

vent potential negative consequences for the environment and human health.

## 1.3 Compliance with RoHS Directive

The product you have purchased complies with EU RoHS Directive (2011/65/EU). It does not contain harmful and prohibited materials specified in the Directive.

## 1.4 Package information



Packaging materials of the product are manufactured from recyclable materials in accordance with our National Environment Regulations. Do not dispose of the packaging materials together with the domestic or other wastes. Take them to the packaging material collection points designated by the local authorities.

## 2 Your steam generator

### 2.1 Overview

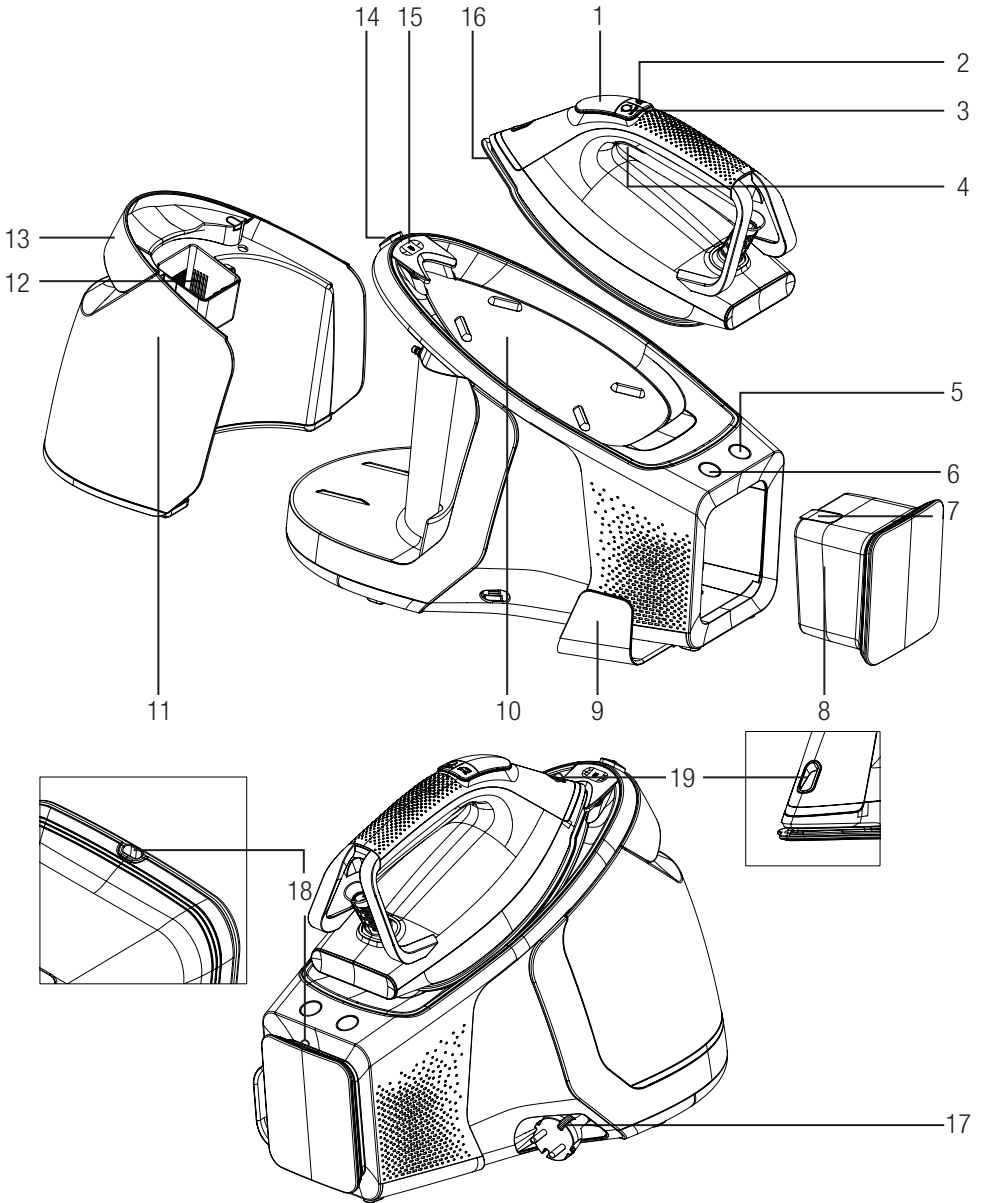

## 2 Your steam generator

### Controls and parts

1. LED Display
2. Automatic steam button
3. Level adjustment button
4. Steam trigger
5. Calc cleaning button
6. On/Off switch
7. Calc box lid
8. Calc box
9. Steam cable clip
10. Iron dock
11. Detachable water tank
12. Water filling hole
13. Tank detach handle
14. Carrying lock unlock button
15. Carrying lock
16. Soleplate
17. Cord wrapping slot
18. Steam release hole
19. LED light

### 2.2 Technical data

|  |                   |
|--|-------------------|
| <b>Power source</b>                          | 220-240V~ 50-60Hz |
| <b>Power consumption</b>                     | 2520-3000 W       |
| <b>Steam pressure</b>                        | 8 bar             |
| <b>Continuous steam amount (up to g/min)</b> | 165 g/min         |
| <b>Intense steam (up to g)</b>               | 600 g*            |















\*Measured by pulling and releasing the steam trigger (4) in 3 second intervals for 30 minute usage, in maximum heat level and turbo steam mode. Iron mode was switched to turbo steam mode in every 12th minute. (see 3.11)

The rights to make technical and design changes are reserved.

## 2 Your steam generator

### LED display and buttons

| LED Display  | Symbols   | Descriptions  |
|--|---|---|
|  |    | Temperature settings  |
|  |    | Steam   |
|  |    | Turbo steam mode  |
|  |    | Smart-Hygiene mode  |
|  |    | Automatic steam sensor indicator  |
|  |    | Auto-Off indicator  |
|  |    | Water tank empty indicator  |
| <b>Buttons</b>   |   |   |
| Level adjustment button  |    | Each time you press on level adjustment button (3), you can switch between iron setting modes "Smart-Hygiene, Temperature 1, Temperature 2, Temperature 3, and Max". Pressing and holding the button for 3 seconds <b>will activate Turbo steam mode</b>                                  |
| Automatic steam sensor button  |  | Use it to activate and disable automatic steam sensor.<br>To activate, press automatic steam sensor button (2). Steam sensor indicator will be displayed on the LED display.<br>To disable, press automatic steam sensor button (2). Steam sensor indicator on the LED display will fade. |
| Calc cleaning button   |  | You can perform descaling with this button.   |
| On/Off switch  |  | You can turn on/off your appliance with this switch.  |

## 3 Operation

### 3.1 Intended use

The appliance is intended for home use and ironing only, it is not suitable for professional use.

### 3.2 First operation

Remove the protecting film on the LED display (1). On initial operation, fill the water tank (11) and generate steam for 10-15 minutes to remove any production residue (see. 3.4).



There may be a light odour on the initial use of the appliance. This will return to normal after a few uses.

### 3.3 Ironing tips

- The appliance will heat up in short; use low temperature settings when ironing synthetic, silk or similar fabrics.
- Reverse iron flammable fabrics (silk, etc.) or use the appliance in **“Smart+Hygiene”** mode.
- When ironing fabrics like velvet, use little pressure and iron in one direction.
- In coloured silk fabrics, steaming may cause stains. Do not use steam.
- 100% pure wool fabrics may be ironed using steam.
- Ironing woolen clothes may cause flaming. Iron on the reverse side.



**WARNING:** Do not contact metal parts like zippers, pins or buttons with the iron. This will damage the iron's soleplate.

### 3.4 Filling the water tank



**WARNINGS:**

- If you are going to fill water while the water tank is still on the steam generator, make sure the appliance is unplugged.
- Do not put perfume, vinegar, soda, descaling agents, ironing aids and other chemicals into the water tank.

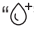

- Water tank empty “” sign will illuminate when the tank is empty. Appliance will not produce steam when the steam trigger is pulled.
- Your appliance is designed for using tap water. If the tap water in your region is extremely calcareous, use the tap water mixed with drinking water.



## 3 Operation

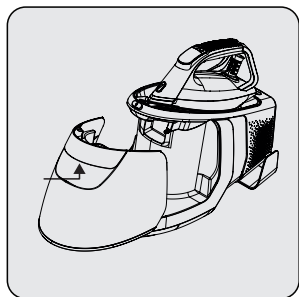

Remove the water tank (11) by holding it from the tank detach handle (13) and pulling.

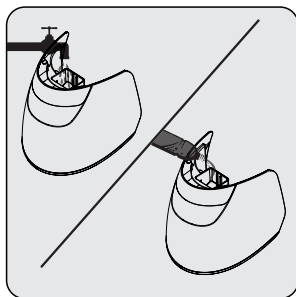

Fill the water tank (11) up to Max line.

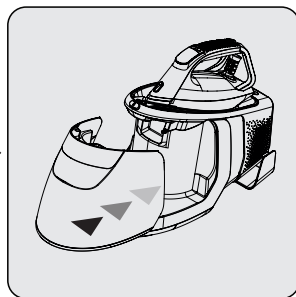

Place back the water tank (11). Make sure the water tank is properly seated.

### 3.5 Carrying lock locking/unlocking

This function is designed to allow easy carriage of iron with the dock.

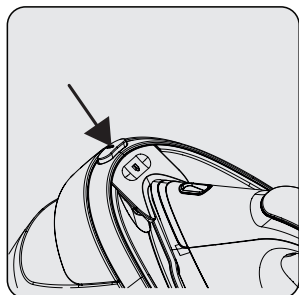

To detach the iron from the dock, push on the carrying lock unlock button (14).

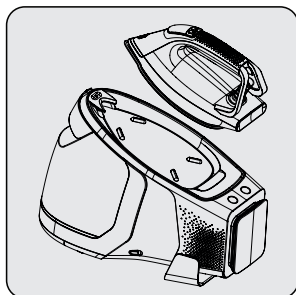

The lock will be unlocked and you will be able to lift the iron from the dock.

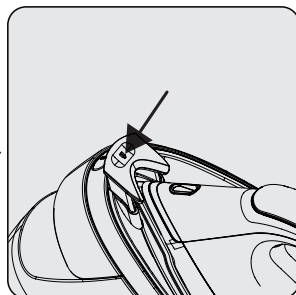

To lock the iron to the dock, push on the carrying lock (15).

### 3.6 Temperature setting



You can safely iron every fabric type that can withstand ironing, using **“Smart-Hygiene”** mode. You can perform steam ironing by using the steam trigger (4) at this stage.



#### WARNINGS:

- You can perform steam ironing in every temperature setting except “•” Pull the steam trigger (4) for steam ironing.
- For ironing, follow the ironing instructions on the fabric label.

## 3 Operation

| Type of Fabric | Settings | Steam Setting     |
|----------------|----------|-------------------|
| Synthetic      | •        | No Steam          |
| Silk goods     | ••       | Steam/Turbo Steam |
| Cotton         | •••      | Steam/Turbo Steam |
| Linens-Jeans   | Max      | Steam/Turbo Steam |

The appliance starts on the **“Smart-Hygiene”** mode. This level provides a safe temperature and steam amount for every fabric that are suitable for ironing.

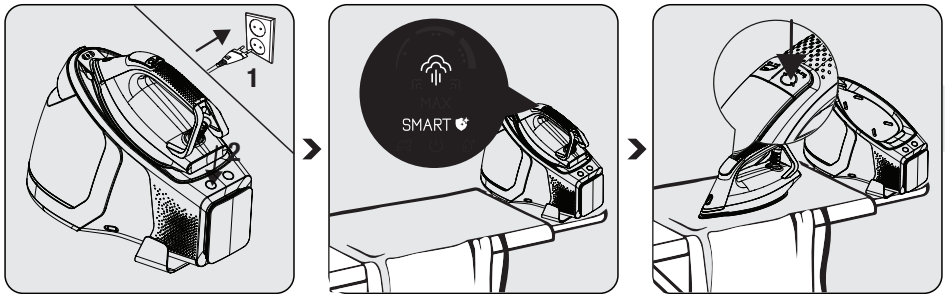

Plug in the power cord and press the on/off switch.

– The light on the on/off button will illuminate and you will hear a beep sound.

LED display (1) will blink until the appliance is ready.

– LED display (1) will remain on when ready, and you will hear a beep sound.

You can set the fabric-appropriate temperature using the level adjustment button (3) and start ironing.

### 3.7 Dry ironing



- Unless you pull the steam trigger (4) or push on the automatic steam sensor button (2), your appliance will not generate steam.
- Pulling the steam trigger (4) will not generate steam when the temperature setting is in “•” mode.

### 3.8 Steam ironing



- Pull the steam trigger (4) for steam ironing. If you keep pulling the steam trigger (4) continuously for 1 minute, the appliance will stop generating steam.
- Pump operation may cause noise during water intake, this is normal.
- To activate automatic steam generation function, you can push on the automatic steam button (2).
- Automatic steam may only be activated when the iron is moving horizontally.

### 3 Operation

You can use level adjustment button (3) to adjust temperature setting. (see 3.6).

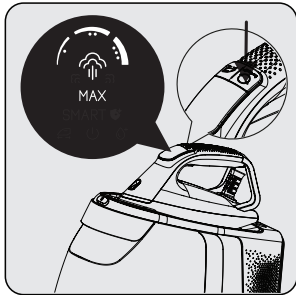

Set the fabric-appropriate temperature and steam using the level adjustment button (3). (See 3.6)

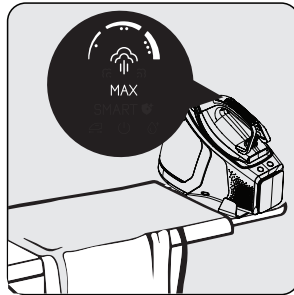

LED display (1) will blink until the appliance is ready.



LED display (1) will remain on when ready, and you will hear a beep sound indicating that your appliance is ready for ironing.

#### WARNINGS:



- Your selection shall comply with the type of the cloth to be ironed.
- Blinking temperature setting symbols on the LED display (1) indicates that the soleplate is being prepared to reach the selected temperature. Constant illuminating setting symbols on the LED display (1) indicates that the soleplate has reached the set temperature.



When the appliance is ready for ironing, move the iron horizontally on the cloth to be ironed and press the steam trigger (4). As long as you pull the steam trigger, your appliance will provide steam through the soleplate (16).



#### WARNINGS:

- Never direct the steam at people or animals.
- Never touch the hot soleplate (16).

## 3 Operation

### 3.9 Automatic steam function

Steam sensor detects your irons motion and provides right amount of steam without using the steam trigger (4) according to the mode you selected.

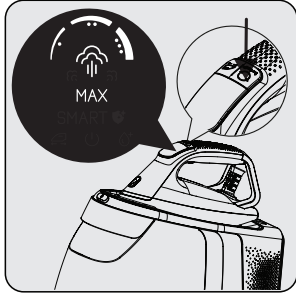

Set the fabric-appropriate temperature and steam using the level adjustment button (3). (See 3.6)

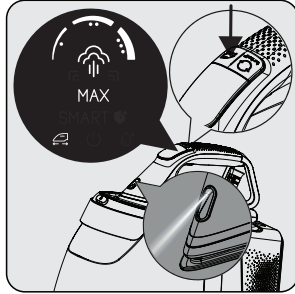

Push the automatic steam button (2) to activate automatic steam function.

- Sensor will be activated and the LED display will display “”.
- At the same time, led light (19) in front of the iron will illuminate.

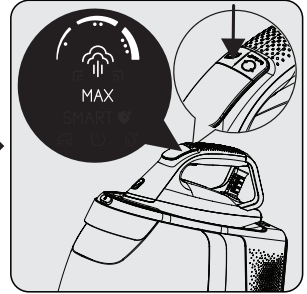

Push the automatic steam button (2) to disable automatic steam function.

- Sensor will be disabled and the “” on the LED display will fade.
- Led light (19) will disappear.



Led light in front of the iron will only illuminate when the automatic steam function is activated.

### 3.10 Intense steam

Pulling and releasing the steam trigger (4) once will provide intense steam.



- Repeatedly pulling the steam trigger (4) may decrease intense steam's effect.
- Intense steam's effect may decrease after using continuous steam by pulling and holding the steam trigger (4) or using the automatic steam function.



**WARNING:** Never direct the steam at people or animals.

## 3 Operation

### 3.11 Turbo mode



- Use the turbo steam feature when you want more steam and for quick ironing performance on thicker clothes.
- After 12 minutes of operation on turbo steam level, the appliance automatically disables turbo steam function.
- You may use the turbo steam function in every mode except “•”.

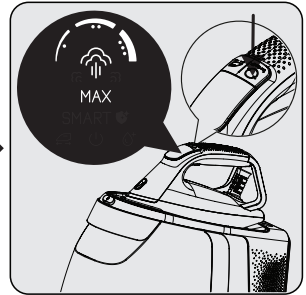
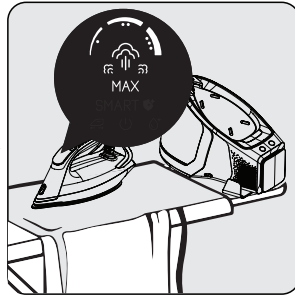
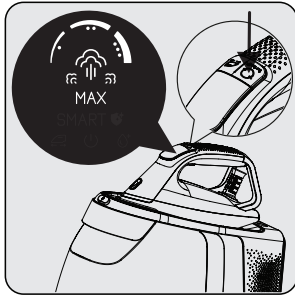

Push the level adjustment button (3) and hold for 3 seconds.  
– Turbo steam symbol “” will appear on the display.

LED display (1) will blink until the appliance is ready.  
– LED display (1) will remain on when ready, and you will hear a beep sound indicating that your appliance is ready for ironing.

To exit turbo steam mode, push the level adjustment button (3).  
– Turbo steam symbol “” will disappear from the display.

### 3.12 Vertical steam

You can use the steam feature also while the iron is in vertical position (see 3.8). Using the vertical steam function, you can iron your curtains or hanged clothes. Keep the appliance 15-30 cm away from clothing and curtains.



You may also use the turbo steam feature (see 3.11).

1. Push the on/off button (6) and hold for 3 seconds when you complete ironing.
  - Lights on the LED display (1) will fade.
2. Unplug the appliance and let it cool.

## 3 Operation

### 3.13 Automatic shut off

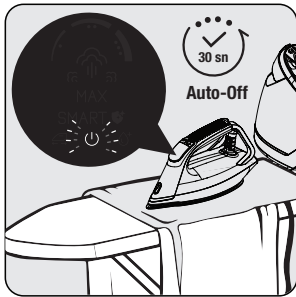

Iron will automatically turn off if it does not move horizontally for 30 seconds or any buttons are pressed.

- Auto shut off “⏻” indicator will continuously illuminate on the LED display (1).

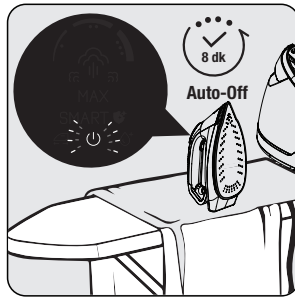

Iron will automatically turn off if it does not move vertically for 8 minutes or any buttons are pressed.

- Auto shut off “⏻” indicator will continuously illuminate on the LED display (1).

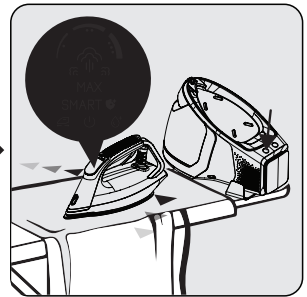

Auto shut off “⏻” indicator will turn off after you move the iron or push any button. LED display (1) will blink until the iron is ready again.

- LED display (1) will remain on when ready, and you will hear a beep sound indicating that your appliance is ready for ironing.



It may take about 60 seconds for the soleplate (16) temperature to reach its previous level.



**WARNING:** The appliance will turn off automatically if no buttons are pushed or the appliance is not moved in 10 minutes. On/Off switch (6) will start blinking. Press the on/off button (6) to re-operate the appliance.

## 4 Cleaning and maintenance

### 4.1 Calc cleaning



- You may start calc cleaning operation when the calc cleaning button (5) “Calc<sup>®</sup>Box” is lit by pushing on the button.
- Before starting calc cleaning, make sure that the calc box (8) is empty.
- When the calc cleaning time is reached, the calc cleaning button (5) will remain lit for 20 seconds and a “beep” sound will be heard on intervals. If you do not start calc cleaning, the calc cleaning button (5) will turn off and the cleaning will start automatically next time you start ironing.
- If the appliance is unplugged or power outage occurs during calc cleaning, the operation will continue on the next time the appliance starts.
- Each time you turn on the appliance, the calc cleaning button (5) will illuminate for 10 seconds if the tank is available for cleaning. If you push on the calc cleaning button (5) within this period, cleaning operation will begin. If you do not push, the calc cleaning button (5) will turn off and the appliance will continue regular operation.



You will hear a “beep” sound if the calc box (8) is filled with water during cleaning. First, empty the calc box (8) and then replace properly.



**WARNING:** During calc cleaning, do not reach for the steam release hole (18) that is located on the calc box (8).

## 4 Cleaning and maintenance

When the “Calc<sup>+</sup> BOX” sign is lit, you may start your irons calc cleaning operation.

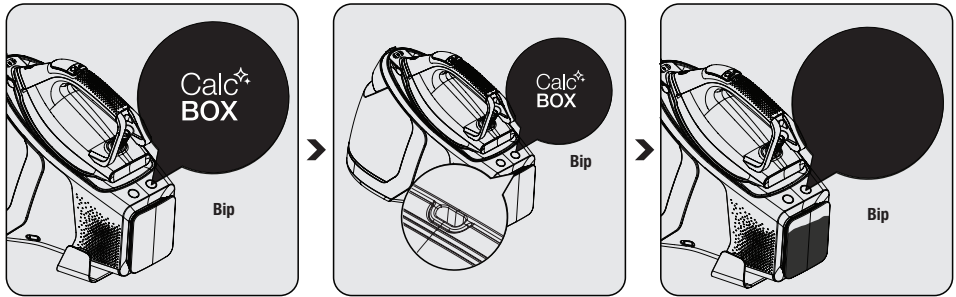

The calc cleaning button “Calc<sup>+</sup> BOX” (5) will remain lit for 20 seconds and alerts with a “beep” sound. This indicates the time for calc cleaning.

Push the calc cleaning button (5).

- A beep sound will be heard and calc cleaning will start.
- During operation, calc cleaning button “Calc<sup>+</sup> BOX” (5) will blink.
- Do not reach for the steam relief hole (18) while the operation continues.

Once the calc cleaning is completed, the calc cleaning button “Calc<sup>+</sup> BOX” (5) will turn off and a long “beep” sound alert will be heard.

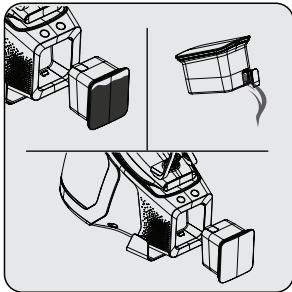

To empty the calc box (8), open the lid (7) and empty. Then, make sure the calc box (8) is properly seated.

- Iron will be ready for ironing in a few minutes.



## 4 Cleaning and maintenance

### WARNINGS:

- During calc cleaning operation (before the beep alert) do not remove the calc box (8) from its place.
- If you remove the calc box (8) from its place during calc cleaning, the operation will stop and an audible warning will be given. There may be water leakage at this point. When the calc box (8) is placed back into its place, calc cleaning will continue.
- If the calc box is (8) pulled during ironing, a long “beep” alert will be heard and calc cleaning button (5) will start blinking.
- Do not turn off or unplug your appliance before the “CalcBox” light is completely turned off.



### 4.2 Cleaning

### WARNINGS:

- Do not immerse the iron dock (10) in water or other liquids. Never put vinegar, descaler, soda, perfume or other ironing aids into the appliance.
- Do not use benzene, solvents, abrasive cleaners or hard brushes to clean the appliance.
- Do not wash your appliance under running water or immerse it in water or other liquids.
- Do not use abrasive cleaning agents to clean the baseplate (16).

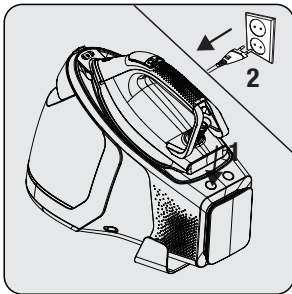

Turn off and unplug the appliance before cleaning.

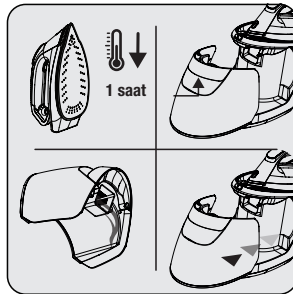

Wait for the appliance to completely cool down. Drain the remaining water from the water tank (11).

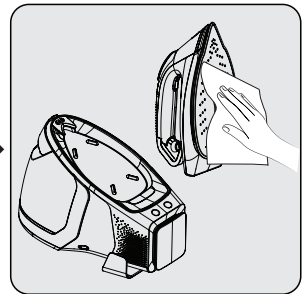

Use a damp cloth to clean the outer part of the appliance. Then wait for it to dry completely. Wipe the sediments and residues on the soleplate (16) with a lightly dampened cloth.

## 4 Cleaning and maintenance

### 4.3 Carrying lock and cable rewinding

This function is designed to allow easy carriage of iron with the dock.

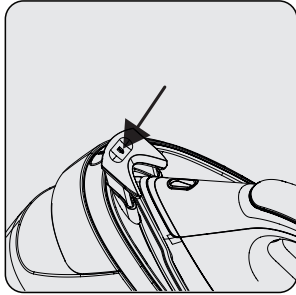

Place the iron on the dock (10) and push on the carrying lock (15) to lock the iron.

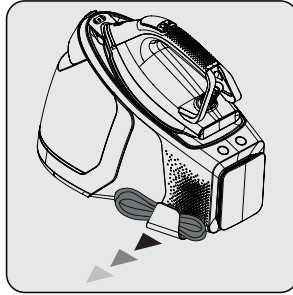

Pull the steam cable clip (9) and place the cable.

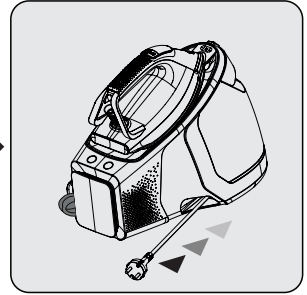

Pull and release the power cord. Cable will be wrapped into the wrapping slot (17).



You may carry the appliance by holding it from the handle.

### 4.4 Storage

- If you do not intend to use the steam generator for a long time, store it carefully.
- Unplug the appliance and wait for it to cool down before storing.
- Drain the water tank (11).
- Lock the handling lock (10) of the appliance (see 4.3).
- Store the appliance in a cool and dry environment.
- Ensure that the appliance is kept out of reach of children.

### 4.5 Transport and shipping

- During transport and shipping, carry the appliance with its original packaging. The packaging of the appliance will protect the appliance against physical damage.
- Do not place heavy objects on the appliance or the package. The appliance may get damaged.
- If the appliance is dropped, the appliance may not operate or permanent damage may occur.

## 5 Troubleshooting

| Problem   | Possible cause  | Solution  |
|---|---|---|
| The base does not heat (16) although the appliance is plugged.              | There may be a problem with the connection.   | Check the plug and the power cord of the appliance  |
|   | Press the on/off button (6).  | Contact the authorized service if the appliance does not operate although the appliance is plugged and you have pressed the on/off (6) button.                    |
| The appliance does not produce steam.                                       | The amount of water in the water tank (11) may be insufficient.   | Fill water into the water tank up to the MAX line (see 3.4).  |
|   | Check if the water reservoir (11) is installed in its housing.  | The appliance does not provide steam if the temperature is set to "●" position. Adjust the temperature setting as "Smart-Hygiene mode, ●●, ●●● or MAX" (see 3.6). |
| Water drips onto the fabric.  | Water may come out when you press the steam trigger (4) before the appliance reaches the set temperature. | The appliance is ready for ironing the adjusted temperature is shown on the LED display (1).  |
| Sediments and residues fall off from the base (16) while ironing.           | Such sediments may occur if the water you use in your appliance is too calcareous.                        | Fill the water reservoir of the appliance by mixing the tap water and drinking water for your next ironing operations.  |
| There are stains on the base (16).  | Wet clothes are ironed / scale stains have occurred on the base (16).                                     | Wipe the sediments and residues with a lightly dampened cloth after the appliance is cooled down adequately.  |
| The on/off button (6) of the appliance blinks.                              | The appliance may have switched to automatic power off mode.  | Press the on/off button (7) (see 3.12).   |
| Calc cleaning button $\text{Calc}^{\star}$<br>$\text{BOX}$ (5) is blinking. | It is time for calc cleaning.   | Perform the calc cleaning operation (see 4.1).  |
| Icons on the LED display (1) are not clear.                                 | The protecting film on the LED display (1) may be still on.   | Remove the protecting film on the LED display (1).  |